

INSTALLATION INSTRUCTIONS: PART# 5329

9" Bolt-On Axle Bracket for James Duff Torque Tamer

CONTENTS:

- 1 Zinc Plated Torque Tamer Bracket
- 4 3/8"-24 Third Member Studs
- 4 3/8" SAE Plated Washers
- 4 3/8" Large Washers
- 2 3/8"-24 GR5 Nuts
- 4 3/8"-24 Locking Nuts
- 1 3/4"-10 x 4" GR8 Bolt
- 1 3/4"-10 Nyloc Nut
- 2 3/4" USS Washer
- 2 Heim Spacers

TOOLS REQUIRED:

- Brass hammer
- 9/16" deep well 3/8" drive socket
- 1/2" non ratcheting box end wrench
- 3/8" Ratchet
- Power drill with a 10mm drill bit
- Wheel Bearing Grease



865.938.6696 www.dufftuff.com
6609 Bronco Ln.
Knoxville, TN 37921

1/1 3/23

DISCLAIMER: DO NOT USE FOR ROCK CRAWLING or OVER 400 HP AT THE CRANK.

1. Chock the front wheels & break loose the 4 bolts that hold the rear driveshaft to the yolk.
2. Using a Jack & 2 Jack stands, Remove rear wheels & jack your rear axle up and support it with **BOTH** jack stands, make sure it has a solid and level foundation to rest on.
3. Remove brake rotor/drum assembly.
4. Place drain pan under axle end and remove the nuts holding the axle shaft plate and slide your axles out, (you may need to use a slide hammer to remove them) Now is a great time to inspect your wheel bearings, axle seals, and axle shafts for wear/damage as well as your wheel studs.. Replace if needed.
5. Using the 1/2" box end wrench remove the rear driveshaft.
6. Place drain pan under the axle end. Using a 9/16" deep well socket and box end wrench, remove third member nuts, and remove third member. Now is a great time to inspect your differential for wear.
7. Using a brass hammer, drive the 4 original studs out, they are the 4 studs furthest to the drivers side of the axle. Please refer to the install video at [youtube.com/broncogarage](https://www.youtube.com/broncogarage) for further clarification. -Coming Soon
8. Place a shop rag on the inside of the axle, behind the now exposed bolt holes to catch any stray metal shavings.
9. For every hole dip a 10mm drill bit in wheel bearing grease, and drill the 4 holes, do not over drill the holes - Just one pass. The wheel bearing grease will help catch metal shavings.
10. On every drilled hole, check for burrs on the backside, if there are any, use a small round file to remove them.
11. Remove the shop rag carefully so you don't drop any metal shavings, inspect the axle housing for any extra debris on the back side of all 4 holes you just drilled out.
12. Insert the supplied extended length studs, and seat them. Using the 4 supplied 3/8" large flat washers and a 3/8" - 24 non locking nut, attach a ratcheting wrench to draw the stud into the axle. Check to make sure it is fully seated on the back side.
13. Once all 4 studs are fully seated, you can now opt to upgrade the rest of the studs, clean the mating surface & install the required Lube Locker gasket, and re-seat your third member.

Figure A

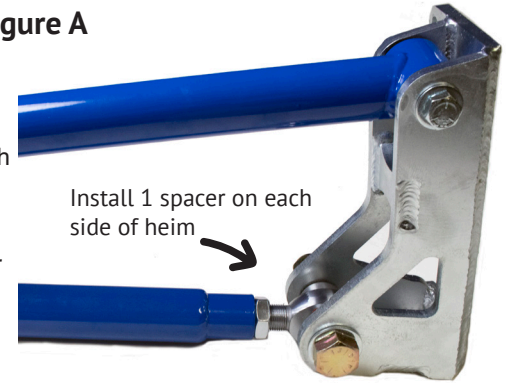

Install 1 spacer on each side of heim

NOTE: We do not recommend RTV as it creates misalignment issues with the 3rd member and axle shafts.

14. Slide the Torque Tamer bracket over the 4 newly installed studs, install the supplied washers and nuts over the top and torque the whole assembly in a star pattern all 10 nuts to 20 ft lbs, and then again to 40 ft lbs.

15. If you purchased this bracket after you have already purchased your torque tamer, you might have to move the crossmember forward 1 inch to prevent the shackles from making contact with the crossmember. Next, reinstall your torque tamer arm. Use the supplied 3/4-10 bolt, washers, and nut to fasten the heim joint down. At this point you can opt re-use your existing hardware and bushings or purchase and install the bushing hardware refresh kit. Torque the 3/4 bolt to 110 ft-lbs.

NOTE: Heim spacers go on each side of the heim - push bar over to install the inside spacer. See Figure A.

16. Reinsert your axle shafts and tighten the 4 retaining plate bolts on each side torque to factory specifications. Reinstall your brake drums/rotors. Inspect for wear. Consider refreshing your pads/rotors/drums at this time and check your drum adjustment.

17. Fill your differential with your preferred fluid and reinstall the fill plug.

18. Reinstall your wheels and lower the truck off of the jack stands. Torque your wheels to 100 ft lbs.

19. After driving 50 miles or going off road, re-torque all hardware.

LIMITED WARRANTY

James Duff Inc. warrants our products to the original purchaser to be free from defects in materials and workmanship. Warranty periods begin at the date of purchase and varies by product. Shocks have a limited lifetime warranty. Headers, Radiators and Suspension Products, Power Brake Boosters and Master Cylinders have a one year warranty. Adapters and soft goods such as upholstery, vinyl and rubber products have a 90 day warranty. All warranties are to the original purchaser with proof of purchase only. Such obligations under this warranty shall be limited to the repair or replacement, at JDI's discretion, of any assembly or part which upon examination by JDI proves to be defective. Any costs of removal, installation, reinstallation or freight charges are expressly excluded from this warranty. This warranty covers only manufacturers defects, and does not cover product finish or damage resulting from abuse, misuse, negligence, racing, alteration, accident or damage in transit.

All returns must be pre-authorized by JDI and accompanied with a Return Goods Authorization Number (RGA) and a dated proof of purchase. Returns must be made within 90 days of purchase, packaged sufficiently to prevent damage in shipment and sent prepaid to JDI, 6609 Bronco Lane, Knoxville, TN 37921 Returns without an RGA# will be refused.

This warranty is expressly in lieu of all other warranties, expressed or implied, including the implied warranties of merchantability and fitness for use. This warranty gives you specific legal rights including other rights that vary from state to state. Some states do not allow limitations on how long an implied warranty lasts, or do not allow the exclusion of limitation of incidental or consequential damages, so the above limitations and/or exclusions may not apply to you.

